

Sherwood Forest Business Park



ETS Interests, Ltd.

Sherwood Forest Business Park

1330 Sherwood Forest

Houston, TX 77043

Property Type: Industrial/ Warehouse

Availability: Lease

Min. Lease Rate: \$0.45 Per Sq. Ft.

- Terms: 12 to 60 months
- Total Sq. Ft. - 57,400
- Eave Height: 14'
- Door Size: 12'X12'
- Electrical Svc.: 200 Amp 3 Phase
- Metal Building

Sherwood Forest Business Park

101	4,500 S.F.
102	1,500 S.F.
103	1,500 S.F.
104	1,500 S.F.
105	1,800 S.F.
107	1,800 S.F.
107	3,600 S.F.
108	5,400 S.F.

201	1,875 S.F.
202	3,700 S.F.
202-A	1,875 S.F.
203	1,875 S.F.
204	2,345 S.F.
205	4,500 S.F.
206	4,500 S.F.
207	4,500 S.F.

301	4,400 S.F.
302	4,400 S.F.

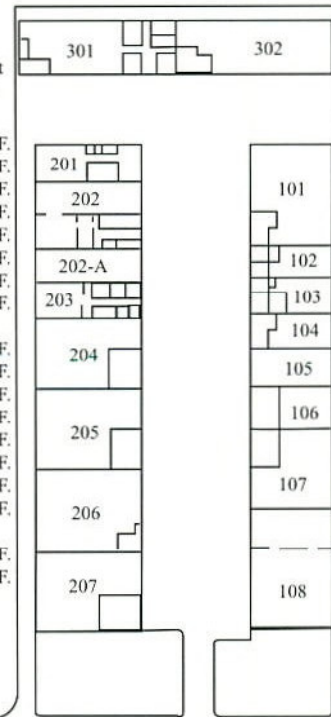

Sherwood Forest Business Park is conveniently located in West Houston close to I-10 and the West Sam Houston Tollway. Approximately 20 miles from downtown.

Houston Real Estate Services

1771 Upland Drive, Suite 101 Houston, Texas 77043-3513

Office: (713) 984-0199 • Fax: (713) 984-0196